

BRIKO

MAPLUS *Ski Wax*

WAX & TOOLS 2013-2014



(I) (GB) (F) (D) (RUS) (CZ)



WORLD RECORD
251.40 km/h



WAX & TOOLS INDEX

WAX & TOOLS	
SKI WAX INTRO	02
RACING WAX CHART	04
PERFLUORINATED WAX FP4	06
FP4 POWDER	06
FP4 SPRAY	06
FP4 SOLID	07
HIGH FLUORINATED PARAFFIN HP3	08
HP3 SOLID	08
HP3 LIQUID	09
LOW FLUORINATED PARAFFIN LP2	10
LP2 SOLID	10
LP2 LIQUID	11
BASE PARAFFIN BP1	12
BP1 SOLID	12
BP1 LIQUID	13
SATURATION & PROTECTION BASE	14
SOLID RACING BASE	14
LIQUID RACING BASE	14
CLEANERS	15
FLUORCLEAN	15
CLEAN	15
UNIVERSAL WAX	16
SOLID	16
SOLID FLUORINATED	16
GRANULAR	16
LIQUID	16
SUPER GLIDE WAX	17
SKIN GLIDE WAX	18
ANTI ICE	18
GLIDING KIT	19
GRIP WAX	20
STICK	20
FLUORO STICK	20
KLISTER	21
FLUORO KLISTER	21
KIT & DISPLAY	22
GENERAL FEATURES	23
SKI MAN BOX KIT	24
SPEED FABRIC ROLLERS	25
ROTO BRUSHES	26
MANUAL BRUSHES	29
WAXING TOOLS	31
SKI LAB ACCESSORIES	35
SKI FILES	36
DIAFACE & DIAMOND	38
STONES	39
SKI MAN FOLDING TABLES	40
WAXING IRONS	42
MAINTENANCE SOLES	43
SKI AND SNOWBOARD VISES	44
EDGE SHARPENERS	47
NORDIC STRUCTURE TOOLS	51
SKI ROLLS	52
ACCESSORIES	56

WAX & TOOLS

SKI WAX INTRO



Per la stagione 2013-2014 la gamma di scioline BRIKO-MAPLUS *Ski Wax* si divide in 4 linee di prodotti facilmente comprensibili e studiati per soddisfare le esigenze di ogni sciatore:

RACE WAX

FP4 (COLD-MED-HOT-SUPERMED) Powder-Spray-Solid – Cera perfluorurata da utilizzare in sovrapposizione alle paraffine fluorurate in caso di umidità intermedia ed elevata (50%-100%)

HP3 (GREEN-BLUE-VIOLET-RED-YELLOW 1/2-ORANGE 1/2) Solid-Liquid Paraffina ad alto contenuto di fluoro per uso agonistico in condizioni di umidità medio-alta (60%-90%) o come base per sovrapporre le cere perfluorurate FP4.

LP2 (GREEN-BLUE-VIOLET-RED-YELLOW-ORANGE) Solid-Liquid Paraffina a basso contenuto di fluoro per allenamento ed uso sportivo, e per uso agonistico in condizioni di umidità medio-bassa (30%-60%) o come base per sovrapporre le cere perfluorurate FP4.

BP1 (GREEN-BLUE-VIOLET-RED-YELLOW-ORANGE) Solid-Liquid Paraffina alto e medio fondente indicata per la saturazione e la protezione delle solette da gara e per uso agonistico in condizioni di bassa umidità (< 30%). Paraffina per allenamento ed uso sportivo.

SATURATION & PROTECTION BASE (MED BASE - SOFT BASE)

GRIP WAX

STICK – Sciolina di tenuta per nevi nuove, trasformate e artificiali a cristallo fine o con minima metamorfosi distruttiva.

STICK FLUO – Condizioni di utilizzo come stick ma con elevata umidità dell'aria.

KLISTER – Sciolina di tenuta per nevi trasformate e artificiali a cristallo grosso o con elevata metamorfosi distruttiva.

KLISTER FLUO – Condizioni di utilizzo come klister ma con elevata umidità dell'aria.

UNIVERSAL WAX

Universal solid

Universal solid fluo

Universal granular

Universal liquid

Super glide wax

Skin & Base Glide Wax

Super Grip & Glide Wax – No wax ski

Paraffine universali per laboratori, noleggi ed uso sportivo.

KIT LINE

Prodotti di sciocultura con accessori per allenamento e uso sportivo.



The range of BRIKO-MAPLUS *Ski Wax* for the 2013-2014 season is split into 4 straightforward lines bound to satisfy every skier's needs:

RACE WAX

FP4 (COLD-MED-HOT-SUPERMED) – Perfluorinated wax to be applied on top of fluorinated paraffin products for racing use in presence of medium-very high humidity (50% - 100%).

HP3 (GREEN-BLUE-VIOLET-RED-YELLOW 1/2-ORANGE 1/2) Solid-Liquid – High fluoro paraffin for racing use in presence of medium-high humidity (60% - 90%) or as a base before applying perfluorinated waxes FP4.

LP2 (GREEN-BLUE-VIOLET-RED-YELLOW-ORANGE) Solid-Liquid – Low fluoro paraffin for training and leisure, and racing use in presence of low-medium humidity (30% - 60%) or as a base before applying perfluorinated waxes FP4.

BP1 (GREEN-BLUE-VIOLET-RED-YELLOW-ORANGE) Solid-Liquid – High and medium melting point paraffin for saturation and protection of racing ski bases and racing use in presence of low humidity (0% - 30%). Paraffin for training and leisure.

SATURATION & PROTECTION BASE (MED BASE - SOFT BASE)

GRIP WAX

STICK – Grip ski wax for fresh, altered or artificial snow with fine crystals or minimal destructive metamorphosis.

STICK FLUO – As for Stick, but in presence of high atmospheric humidity.

KLISTER – Grip ski wax for altered or artificial snow with large crystals or high destructive metamorphosis.

KLISTER FLUO – As for Klister, but in presence of high atmospheric humidity.

UNIVERSAL WAX

Universal solid

Universal solid fluo

Universal granular

Universal liquid

Super glide wax

Skin & Base Glide Wax

Super Grip & Glide Wax – No wax ski

Paraffin products for workshop, ski-rental and leisure.

KIT LINE

Waxing products with ski tools for training and leisure.



La gamme de fart BRIKO-MAPLUS *Ski Wax* pour la saison 2013-2014 se décompose en 4 catégories afin de satisfaire les besoins de chaque skieur:

RACE WAX

FP4 (COLD-MED-HOT-SUPERMED) Powder-Spray-Solid – Fart 100% fluor, a appliquer pour la compétition en cas d'humidité très élevée. (50% - 100%).

HP3 (GREEN-BLUE-VIOLET-RED-YELLOW 1/2-ORANGE 1/2) Solid-Liquid – Paraffine hautement fluorée pour la compétition en cas d'humidité élevée (60% - 90%). Cette paraffine peut servir de base pour les farts 100% fluor de type FP4.

LP2 (GREEN-BLUE-VIOLET-RED-YELLOW-ORANGE) Solid-Liquid – Paraffine faiblement fluorée pour l'entraînement et le loisir, paraffine de compétition dans des cas d'humidité moyen (30% - 60%). Cette paraffine peut servir de base pour les farts 100% fluor de type FP4.

BP1 (GREEN-BLUE-VIOLET-RED-YELLOW-ORANGE) Solid-Liquid – Paraffine d'imprégnation pour ski neufs, pour protéger les skis en stockage ou encore paraffine de base pour fart de compétition ou bien la compétition en cas de faible humidité (0% - 30%). Paraffine pour l'entraînement et le loisir.

SATURATION & PROTECTION BASE (MED BASE - SOFT BASE)

GRIP WAX

STICK – Fart en poussette pour neige artificiel, fraîche avec des cristaux fins et non métamorphosés.

STICK FLUO – Fart en poussette plus performante en conditions de haute humidité.

KLISTER – Fart de retenu pour neige artificiel transformée, grosse métamorphose des cristaux.

KLISTER FLUO – Fart de retenu plus performant en conditions de haute humidité.

UNIVERSAL WAX

Universal solid

Universal solid fluo

Universal granular

Universal liquid

Super glide wax

Skin & Base Glide Wax

Super Grip & Glide Wax – No wax ski

Paraffine pour les magasins, location et le loisir.

KIT LINE

Gamme des produits de fartage pour l'entraînement et le loisir.



Alle Spraywachse sowie die komplett neue Produktlinie von Pulverwachsen garantieren auch weiterhin außergewöhnliche Ergebnisse, bei allen Schnee-Bedingungen. Die Kollektion der BRIKO-MAPLUS Wachse teilt sich in 4 wichtige Produkt-Linien für die Saison 2013-2014 auf und erfüllt damit alle Bedürfnisse der Skisportler:

RACE WAX

FP4 (COLD-MED-HOT-SUPERMED) Powder-Spray-Solid – Perfluorierte Cera-Wachse für den Renn-Gebrauch als Finish-Wachse über alle fluorierten Paraffin-Wachse, bei mittlerer bis hoher Luftfeuchtigkeit (50 %-100%).
HP3 (GREEN-BLUE-VIOLET-RED-YELLOW 1/2-ORANGE 1/2) Solid-Liquid – High-Fluor-Paraffinwachse für den Renn-Gebrauch bei mittlerer bis hoher Luftfeuchtigkeit (60 %-90%) oder als Base-Wachs unter die perfluorierten Cera-Wachse FP4.

LP2 (GREEN-BLUE-VIOLET-RED-YELLOW-ORANGE) Solid-Liquid – Low-Fluor-Paraffinwachse für den Gebrauch bei niedriger bis mittlerer Luftfeuchtigkeit (30 %-60%) oder als Base-Wachse unter die perfluorierten Cera-Wachse FP4.

BP1 (GREEN-BLUE-VIOLET-RED-YELLOW-ORANGE) Solid-Liquid – Paraffine mit mittleren und hohen Schmelzpunkten für die Sättigung und zum Schutz der Rennbeläge sowie für Rennen bei geringer Luftfeuchtigkeit (0% - 30%). Paraffinwachse für Training und Freizeit.

SATURATION & PROTECTION BASE (MED BASE - SOFT BASE)

GRIP WAX

STICK – Steigwachse für Neuschnee, Altschnee und Kunstschnee mit feinen Kristallen oder für bereits leicht umgewandelten Schnee.

STICK FLUO – Anwendung wie bei Hartwachs-Sticks, jedoch für hohe Luftfeuchtigkeit.

KLISTER – Steigwachs für Altschnee und Kunstschnee mit groben Kristallen oder stark umgewandelten Schnee.

KLISTER FLUO – Anwendung wie bei Klister, jedoch für hohe Luftfeuchtigkeit.

UNIVERSAL WAX

Universal solid
 Universal solid fluo
 Universal granular
 Universal liquid
 Super glide wax
 Skin & Base Glide Wax
 Super Grip & Glide Wax – No wax ski
 Universal-Paraffinwachse für Werkstätten, Verleih und Rennlauf.

KIT LINE

Wachs-Sets mit ski-tools für Training und Freizeit.



Für die Saison 2013 - 2014 g. gamma lyžných mazey BRIKO-MAPLUS *Ski Wax* разделится на 4 линей продуктов легких в понимании и предназначенных для удовлетворения потребностей каждого лыжника

RACE WAX

FP4 (COLD-MED-HOT-SUPERMED) – Порошок-Спрей-Твёрдая – Цера высокофтористая используется для нанесения сверху фтористых парафинов в случае средней и высокой влажности (50% -100%)

HP3 (GREEN-BLUE-VIOLET-RED-YELLOW 1/2-ORANGE 1/2) – Твёрдый – Жидкий – Парафин с высоким содержанием фтора для использования при соревнованиях в условиях средне-высокой влажности (60%-90%) или как база перед нанесением высокофтористой церы FP4.

LP2 (GREEN-BLUE-VIOLET-RED-YELLOW-ORANGE) Твёрдый – Жидкий – Парафин с низким содержанием фтора для тренировок и спортивного использования, а также для использования при соревнованиях при низко-средней влажности (30%-60%) или как база перед нанесением высокофтористой церы FP4.

BP1 (GREEN-BLUE-VIOLET-RED-YELLOW-ORANGE) – Твёрдый – Жидкий – Парафин высокой и средней степени мягкости предназначен для насыщения и защиты скользящей поверхности лыж для соревнований в условиях низкой влажности (< 30%). Парафин для тренировок и спортивного использования.

SATURATION & PROTECTION BASE (MED BASE - SOFT BASE)

GRIP WAX

STICK – Мазь на держание для нового снега, трансформированного и искусственного мелкокристаллического или с минимальными разрушительными изменениями.

STICK FLUO – Условия применения как и stick, но при повышенной влажности воздуха.

KLISTER – Мазь на держание для преобразованного и искусственного крупнокристаллического снега или с повышенными разрушительными изменениями.

KLISTER FLUO – Условия применения как и клистер, но при повышенной влажности воздуха.

UNIVERSAL WAX

Universal solid
 Universal solid fluo
 Universal granular
 Universal liquid
 Super glide wax
 Skin & Base Glide Wax
 Super Grip & Glide Wax – No wax ski

Универсальные парафины для лабораторий, прокатов и спортивного использования.

KIT LINE

Материал для смазки лыж с аксессуарами для тренировок и спортивного использования.



Lyžařské vosky firmy BRIKO-MAPLUS jsou v sezóně 2013-2014 rozděleny do čtyř kategorií tak, aby byly uspokojeny požadavky všech kategorií lyžařů:

RACE WAX

FP4 (COLD-MED-HOT-SUPERMED) – Powder-Spray-Solid - Perfluorovaný závodní vosk pro aplikaci na fluorované parafiny při střední až velmi vysoké vlhkosti (50-100%).

HP3 (GREEN-BLUE-VIOLET-RED-YELLOW 1/2-ORANGE 1/2) – Solid-Liquid - Závodní parafin s vysokým obsahem fluoru pro použití při středně vysoké vlhkosti (60-90%) nebo jako základ před aplikací perfluorovaného vosku FP4.

LP2 (GREEN-BLUE-VIOLET-RED-YELLOW-ORANGE) Solid-Liquid - Parafin s nízkým obsahem fluoru určen pro volný čas, trénink a závody v případě nízké až středně vysoké vlhkosti (30-60%) nebo jako základ před nanesením perfluorovaného vosku FP4.

BP1 (GREEN-BLUE-VIOLET-RED-YELLOW-ORANGE) – Solid-Liquid - Parafin s vysokým a středním bodem tání, který je užíván k nasycení a ochraně povrchu závodních lyží a při závodech za nízké vlhkosti (0-30%).

SATURATION & PROTECTION BASE (MED BASE - SOFT BASE)

GRIP WAX

STICK – Vosk určen pro čerstvý, upravovaný nebo umělý sníh s jemnými krystaly nebo při minimální metamorfóze.

STICK FLUO – Tento vosk je stejně jako „STICK“ určen pro čerstvý, upravený nebo umělý sníh s jemnými krystaly nebo při minimální metamorfóze, avšak používá se v případě vysoké vlhkosti vzduchu.

KLISTER – Vosk určen pro upravovaný nebo umělý sníh s velkými krystaly nebo při vysoké metamorfóze.

KLISTER FLUO – Tento vosk je stejně jako „KLISTER“ určen pro upravovaný nebo umělý sníh s velkými krystaly nebo při vysoké metamorfóze, avšak používá se v případě vysoké vlhkosti vzduchu.

UNIVERSAL WAX





Universal solid
 Universal solid fluo
 Universal granular
 Universal liquid
 Super glide wax
 Skin & Base Glide Wax
 Super Grip & Glide Wax – No wax ski
 Parafinové produkty určené pro dílny, půjčovny lyží a aktivity volného času.

KIT LINE

Vosky s příslušenstvím pro trénink a aktivity volného času.





RACING WAX CHART

USE: 1° Determine snow type - 2° Determine air humidity
3° Determine snow temperature - 4° Select wax

		1° - SNOW AGGRESSIVE									
		ARTIFICIAL			FINE		IN TRASFORMATION			ICY	
											
2° - AIR HUMIDITY		3° - SNOW TEMPERATURE									
		-30°C	-20°C	-13°C	-9°C	-7°C	-5°C	-3°C	-2°C	-1°C	0°C
		-22°F	-4°F	8,6°F	15,8°F	19,5°F	23°F	26,6°F	28,4°F	30,2°F	32°F
< 40% + training and leisure	Solid {	BP1 GREEN								BP1 YELLOW	
		BP1 BLUE				BP1 RED					
	Liquid {	BP1 VIOLET								BP1 ORANGE	
		BP1 COLD				BP1 MED			BP1 HOT		
30% - 60%	Solid {	LP2 GREEN							LP2 YELLOW		
		LP2 BLUE			LP2 RED						
	Liquid {	LP2 VIOLET							LP2 ORANGE		
		LP2 COLD			LP2 MED			LP2 HOT			
60% - 90%	Solid {	HP3 BLUE MOLY COLD ADDITIVE									
		HP3 GREEN						HP3 YELLOW 1/2			
	Liquid {	HP3 BLUE			HP3 RED						
		HP3 VIOLET							HP3 ORANGE 1/2		
> 50% overlay FP4 over LP2 or HP3		HP3 COLD			HP3 MED			HP3 HOT			
		FP4 COLD							FP4 HOT		
							FP4 MED				
		FP4 SUPERMED - HR < 80%									

RACING WAX CHART

USE: 1° Determine snow type - 2° Determine air humidity
3° Determine snow temperature - 4° Select wax

	1° - SNOW NOT AGGRESSIVE									
	MOIST		IN TRASFORMATION		TRANSFORMED		WET			
										
2° - AIR HUMIDITY	3° - SNOW TEMPERATURE									
	-30°C -22°F	-20°C -4°F	-13°C 8,6°F	-9°C 15,8°F	-7°C 19,5°F	-5°C 23°F	-3°C 26,6°F	-2°C 28,4°F	-1°C 30,2°F	0°C 32°F
< 40% + training and leisure	Solid {	BP1 GREEN					BP1 YELLOW			
		BP1 BLUE		BP1 RED						
	Liquid {	BP1 VIOLET			BP1 ORANGE					
		BP1 COLD			BP1 MED			BP1 HOT		
30% - 60%	Solid {	LP2 GREEN					LP2 YELLOW			
		LP2 BLUE		LP2 RED						
	Liquid {	LP2 VIOLET			LP2 ORANGE					
		LP2 COLD			LP2 MED			LP2 HOT		
60% - 90%	Solid {						HP3 ORANGE 2 MOLY HOT ADDITIVE			
		HP3 GREEN					HP3 YELLOW 1/2			
	Liquid {	HP3 BLUE		HP3 RED						
		HP3 VIOLET			HP3 ORANGE 1/2					
> 50% overlay FP4 over LP2 or HP3		FP4 COLD			FP4 HOT					
		FP4 MED								
		FP4 SUPERMED - HR < 80%								

PERFLUORINATED WAX FP4

Alpine/Nordic/Snowboard

FP4 POWDER

FP4 COLD

BMW0640 10 gr
BMW0840 30 gr



all snow
snow temp $-22^{\circ}/-8^{\circ}$
hr 30/60%
 160°C

FP4 MED

BMW0641 10 gr
BMW0841 30 gr



all snow
snow temp $-9^{\circ}/-2^{\circ}$
hr 60/100%
 160°C

FP4 HOT

BMW0642 10 gr
BMW0842 30 gr



all snow
snow temp $-3^{\circ}/0^{\circ}$
hr 60/100%
 160°C

FP4 SUPERMED

BMW0643 10 gr
BMW0843 30 gr



all snow
snow temp $-16^{\circ}/-2^{\circ}$
hr 40/80%
 160°C

FP4 SPRAY

FP4 COLD

BMW0850 50 ml



all snow
snow temp $-22^{\circ}/-8^{\circ}$
hr 30/60%

FP4 MED

BMW0851 50 ml



all snow
snow temp $-9^{\circ}/-2^{\circ}$
hr 60/100%

FP4 HOT

BMW0852 50 ml



all snow
snow temp $-3^{\circ}/0^{\circ}$
hr 60/100%

FP4 SUPERMED

BMW0853 50 ml



all snow
snow temp $-16^{\circ}/-2^{\circ}$
hr 40/80%

FP4 SOLID

FP4 COLD
BMW0860 20 gr



all snow
snow temp -22°/-8°
hr 30/60%

FP4 MED
BMW0861 20 gr



all snow
snow temp -9°/-2°
hr 60/100%

FP4 HOT
BMW0862 20 gr



all snow
snow temp -3°/0°
hr 60/100%

FP4 SUPERMED
BMW0863 20 gr



all snow
snow temp -16°/-2°
hr 40/80%



HIGH FLUORINATED PARAFFIN HP3

Alpine/Nordic/Snowboard

HP3 SOLID

HP3 GREEN POWDER

BMW0900 50 gr



fine snow
snow temp $-30^{\circ}/-10^{\circ}$
hr 60/90% 160°C

HP3 BLUE

BMW0901 50 gr

BMW0911 250 gr

BMW0921 1 kg



snow in transformation
snow temp $-20^{\circ}/-10^{\circ}$
hr 60/90% $150^{\circ}/160^{\circ}\text{C}$

HP3 VIOLET

BMW0902 50 gr

BMW0912 250 gr

BMW0922 1 kg



snow in transformation
snow temp $-12^{\circ}/-6^{\circ}$
hr 60/90% $140^{\circ}/150^{\circ}\text{C}$

HP3 RED

BMW0903 50 gr

BMW0913 250 gr

BMW0923 1 kg



snow in transformation
snow temp $-7^{\circ}/-3^{\circ}$
hr 60/90% $130^{\circ}/140^{\circ}\text{C}$

HP3 BLUE MOLY COLD ADDITIVE

BMW0901M 50 gr

BMW0911M 250 gr

BMW0921M 1 kg



snow dirty and dry
snow temp $-20^{\circ}/-10^{\circ}$
hr 60/90% $150^{\circ}/160^{\circ}\text{C}$

HP3 ORANGE 2 MOLY HOT ADDITIVE

BMW0907M 50 gr

BMW0917M 250 gr

BMW0927M 1 kg



snow dirty and wet
snow temp $-3^{\circ}/0^{\circ}$
hr 60/90% $100^{\circ}/110^{\circ}\text{C}$

HP3 YELLOW 1

BMW0904 50 gr

BMW0914 250 gr

BMW0924 1 kg



new moist snow
snow temp $-4^{\circ}/0^{\circ}$
hr 60/90% $110^{\circ}/120^{\circ}\text{C}$

HP3 YELLOW 2

BMW0905 50 gr

BMW0915 250 gr

BMW0925 1 kg



snow in transformation
snow temp $-5^{\circ}/-1^{\circ}$
hr 60/90% $120^{\circ}/130^{\circ}\text{C}$

HP3 ORANGE 1

BMW0906 50 gr

BMW0916 250 gr

BMW0926 1 kg



old coarse snow
snow temp $-4^{\circ}/0^{\circ}$
hr 60/90% $130^{\circ}/140^{\circ}\text{C}$

HP3 ORANGE 2

BMW0907 50 gr

BMW0917 250 gr

BMW0927 1 kg



wet snow
snow temp $-3^{\circ}/0^{\circ}$
hr 60/90% $100^{\circ}/110^{\circ}\text{C}$

HP3 LIQUID

HP3 COLD

BMW0930 75 ml
BMW0940 0,5 lt



all snow
snow temp -22°/-8°
hr 60/90%

HP3 MED

BMW0931 75 ml
BMW0941 0,5 lt



all snow
snow temp -9°/-2°
hr 60/90%

HP3 HOT

BMW0932 75 ml
BMW0942 0,5 lt



all snow
snow temp -3°/0°
hr 60/90%



FORNITORE UFFICIALE
SCIOLINE FISI



LOW FLUORINATED PARAFFIN LP2

Alpine/Nordic/Snowboard

LP2 SOLID



LP2 GREEN POWDER
BMW0950 100 gr



fine snow
snow temp $-30^{\circ}/-10^{\circ}$
hr 30/60% 160°C

LP2 BLUE
BMW0951 100 gr
BMW0961 250 gr
BMW0971 1 kg



snow in transformation
snow temp $-20^{\circ}/-10^{\circ}$
hr 30/60% 150°/160°C

LP2 VIOLET
BMW0952 100 gr
BMW0962 250 gr
BMW0972 1 kg



snow in transformation
snow temp $-12^{\circ}/-6^{\circ}$
hr 30/60% 140°/150°C

LP2 RED
BMW0953 100 gr
BMW0963 250 gr
BMW0973 1 kg



snow in transformation
snow temp $-7^{\circ}/-3^{\circ}$
hr 30/60% 130°/140°C

LP2 YELLOW
BMW0954 100 gr
BMW0964 250 gr
BMW0974 1 kg



snow in transformation
snow temp $-5^{\circ}/-1^{\circ}$
hr 30/60% 110°/120°C

LP2 ORANGE
BMW0955 100 gr
BMW0965 250 gr
BMW0975 1 kg



old coarse snow
snow temp $-4^{\circ}/0^{\circ}$
hr 30/60% 100°/110°C



LP2 LIQUID

LP2 COLD

BMW0980	75 ml
BMW0983	150 ml
BMW0986	0,5 lt



all snow
snow temp -22°/-8°
hr 30/60%

LP2 MED

BMW0981	75 ml
BMW0984	150 ml
BMW0987	0,5 lt



all snow
snow temp -9°/-2°
hr 30/60%

LP2 HOT

BMW0982	75 ml
BMW0985	150 ml
BMW0988	0,5 lt



all snow
snow temp -3°/0°
hr 30/60%



FORNITORE UFFICIALE
SCIOLINE FIS

BP1 SOLID

BP1 GREEN

BMW0800	100 gr
BMW0810	250 gr
BMW0820	1 kg



fine snow
snow temp $-30^{\circ}/-10^{\circ}$
hr : 40%  1600°C

BP1 BLUE

BMW0801	100 gr
BMW0811	250 gr
BMW0821	1 kg



snow in transformation
snow temp $-20^{\circ}/-10^{\circ}$
hr : 40%  150°/160°C

BP1 VIOLET

BMW0802	100 gr
BMW0812	250 gr
BMW0822	1 kg



snow in transformation
snow temp $-12^{\circ}/-6^{\circ}$
hr : 40%  140°/150°C

BP1 RED

BMW0803	100 gr
BMW0813	250 gr
BMW0823	1 kg



snow in transformation
snow temp $-7^{\circ}/-3^{\circ}$
hr : 40%  130°/140°C

BP1 YELLOW

BMW0804	100 gr
BMW0814	250 gr
BMW0824	1 kg



snow in transformation
snow temp $-5^{\circ}/-1^{\circ}$
hr : 40%  110°/120°C

BP1 ORANGE

BMW0805	100 gr
BMW0815	250 gr
BMW0825	1 kg



old coarse snow
snow temp $-4^{\circ}/0^{\circ}$
hr : 40%  100°/110°C

BP1 COMBI S

BMW0829	4 x 100 gr
---------	------------



(BMW0801-0802-0803-0804)

BP1 LIQUID

BP1 COLD

BMW0830 75 ml
BMW0833 150 ml
BMW0836 0,5 lt



all snow
snow temp -22°/-8°
hr < 40%

BP1 MED

BMW0831 75 ml
BMW0834 150 ml
BMW0837 0,5 lt



all snow
snow temp -9°/-2°
hr < 40%

BP1 HOT

BMW0832 75 ml
BMW0835 150 ml
BMW0838 0,5 lt



all snow
snow temp -3°/0°
hr < 40%

BP1 COMBI L

BMW0839 3 x 75 ml



(BMW0830-0831-0832)



FORNITORE UFFICIALE
SCIOLINE FIS



SATURATION & PROTECTION BASE

Alpine/Nordic/Snowboard

SOLID RACING BASE

MED BASE

BMW0870 250 gr

BMW0875 1 kg



SOFT BASE

BMW0871 250 gr

BMW0876 1 kg



LIQUID RACING BASE

MED BASE

BMW0885 0,5 lt



SOFT BASE

BMW0886 0,5 lt



snow temp $-10^{\circ}/-5^{\circ}$
 130°/140°C

snow temp $-5^{\circ}/0^{\circ}$
 110°/120°C

snow temp $-10^{\circ}/-5^{\circ}$

snow temp $-5^{\circ}/0^{\circ}$



FORNITORE UFFICIALE
SCIOLINE FISI



CLEANERS

Alpine/Nordic/Snowboard

FLUORCLEAN

FLUORCLEAN SPRAY
BMW0750 150 ml



FLUORCLEAN
BMW0751 0,5 lt



FLUORCLEAN
BMW0752 1 lt



CLEAN

CLEAN SPRAY
BMW0755 150 ml



CLEAN
BMW0756 0,5 lt
BMW0757 1 lt



CLEAN
BMW0758 4,9 lt



UNIVERSAL WAX

Alpine/Nordic/Snowboard

UNIVERSAL SOLID

RED

BMW0700 100 gr
BMW0702 1 kg



snow temp $-15^{\circ}/-5^{\circ}$
130°/140°C

YELLOW

BMW0701 100 gr
BMW0703 1 kg



snow temp $-5^{\circ}/0^{\circ}$
110°/120°C

UNIVERSAL SOLID FLUORINATED

RED FLUORO

BMW0705 100 gr
BMW0707 1 kg



snow temp $-15^{\circ}/-5^{\circ}$
130°/140°C

YELLOW

BMW0706 100 gr
BMW0708 1 kg



snow temp $-5^{\circ}/0^{\circ}$
110°/120°C

UNIVERSAL GRANULAR

UNIVERSAL COLD

BMW0710 5 kg
BMW0712 20 kg



snow temp $-15^{\circ}/-5^{\circ}$

UNIVERSAL HOT

BMW0711 5kg
BMW0713 20 kg



snow temp $-5^{\circ}/0^{\circ}$

UNIVERSAL LIQUID

UNIVERSAL

BMW0715 1 lt
BMW0716 4,9 lt



UNIVERSAL WAX SUPER GLIDE WAX

Alpine/Nordic/Snowboard

LIQUID

UNIVERSAL FLUORO

Display Box

BMW0718 12 x 75 ml

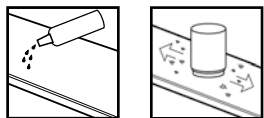

LIQUID

UNIVERSAL FLUORO

Display Box

BMW0741 12 x 150 ml

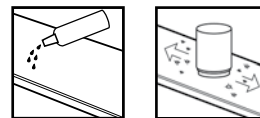

CREAM

UNIVERSAL FLUORO

BMW0722 250 ml



RUB ON

UNIVERSAL FLUORO

BMW0723 100 gr

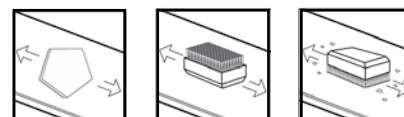

UNIVERSAL WAX
SKIN GLIDE WAX

Mountain/Touring Ski

RUB ON

UNIVERSAL FLUORO
BMW0726 100 gr

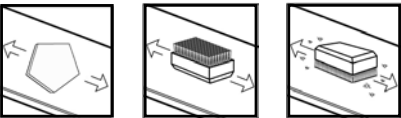

UNIVERSAL WAX
ANTI ICE

Cross-Country Ski

SPRAY

ANTI ICE
BMW0732 150 ml

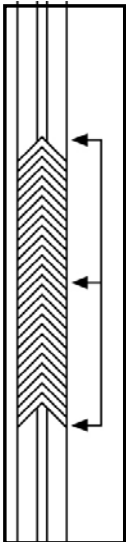

UNIVERSAL KIT

BMW0200 75 ml



BP1 COLD KIT

BMW0201 75 ml



BP1 MED KIT

BMW0202 75 ml



BP1 HOT KIT

BMW0203 75 ml

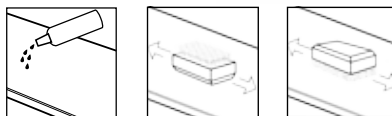

BP1 COMBI + CLEAN KIT

BMW0205 150 ml + 3 x 75 ml



RUB ON KIT

BMW0207 100 gr

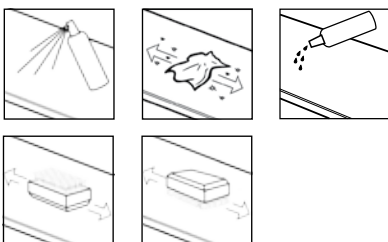

BP1 COMBI KIT

BMW0204 4 x cold-med-hot x 75 ml

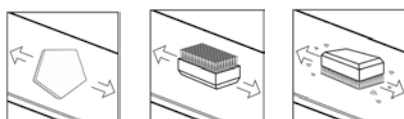

GRIP WAX

Cross-Country

STICK

ORANGE MWOS60	45gr	GREEN MWOS61	45gr	BLUE MWOS62	45gr	VIOLET MWOS63	45gr	YELLOW MWOS64	45gr
--------------------------------	------	-------------------------------	------	------------------------------	------	--------------------------------	------	--------------------------------	------

BASE STICK



air temp -20°/+2°



air temp -20°/-8°



air temp -7°/-3°



air temp -3°/0°



air temp 0°/+2°

FLUORO STICK

GREEN MWOSF10	45gr	BLUE MWOSF11	45gr	VIOLET MWOSF12	45gr
--------------------------------	------	-------------------------------	------	---------------------------------	------



air temp -13°/-5°



air temp -4°/-2°



air temp -2°/+1°

KLISTER

UNIVERSAL
MWOK80 60 gr



air temp -5°/+5°

SILVER
MWOK81 60 gr



air temp -5°/-2°

GREEN
MWOK82 60 gr



air temp -9°/+5°

BASE KLISTER

VIOLET
MWOK83 60 gr



air temp -6°/-3°

RED
MWOK84 60 gr



air temp -2°/+1°

YELLOW
MWOK85 60 gr



air temp -1°/+5°

FLURO KLISTER

UNIVERSAL
MWOKF20 60 gr



air temp -5°/+5°

RED
MWOKF21 60 gr



air temp -2°/+1°

YELLOW
MWOKF22 60 gr



air temp -1°/+5°

KIT & DISPLAY

GRIP WAX KIT
MWOSK050



GRIP WAX DISPLAY
MWOSK550



(MWOS62-63-64 + K80 + MT0113 + MT0510) (10 sticks - 6 klister for each item)

STICK												
SNOW TYPE	FINE (falling, new and few transformed) ARTIFICIAL MOIST (falling and new)											
AIR HUMIDITY	AIR TEMPERATURE											
	-20°C -4°F	-13°C 8,6°F	-9°C 15,8°F	-7°C 19,5°F	-5°C 23°F	-4°C 25°F	-3°C 26,6°F	-2°C 28,4°F	-1°C 30,2°F	0°C 32°F	1°C 34°F	2° C 36°F
ALL CONDITIONS	STICK BASE S60 ORANGE											
30% - 70%	S61 GREEN			S62 BLUE					S64 YELLOW			
70% - 100%	SF 10 GREEN				SF11 BLUE			SF12 VIOLET				

KLISTER													
SNOW TYPE	ICY TRANSFORMED WET												
AIR HUMIDITY	AIR TEMPERATURE												
	-9°C 15,8°F	-8°C 18°F	-7°C 19,5°F	-6°C 21°F	-5°C 23°F	-4°C 25°F	-3°C 26,6°F	-2°C 28,4°F	-1°C 30,2°F	0°C 32°F	1°C 34°F	5° C 41°F	
ALL CONDITIONS	KLISTER BASE K82 GREEN												
30% - 70%	S61 GREEN			K83 VIOLET				K84 RED					
70% - 100%					K81 SILVER			K80 BLUE		KF21 RED			
									KF22 YELLOW				
						KF20 BLUE							

GENERAL FEATURES

INDICAZIONI:

E' consigliabile mettere sempre uno strato di base stick S60 ORANGE a caldo con il ferro sciolinatore. Lo spessore dello strato di base è in funzione dell'abrasività della neve. Maggiore sarà l'abrasività, maggiore sarà lo strato da applicare. La sciolinatura completa richiede come minimo 3 strati di stick sovrapposti anche differenti e di volta in volta tirati con il sughero sintetico.

E' consigliabile mettere sempre uno strato di base klister K82 GREEN a caldo con il ferro sciolinatore. Lo spessore dello strato di base è in funzione dell'abrasività della neve. La sciolinatura completa richiede come minimo 2 strati di klister anche mischiati, e di volta in volta tirati con il pollice. Con neve che tende a ghiacciare è consigliabile usare le stick come indicato in tabella per coprire le klister evitando che ghiaccino compromettendo la tenuta. E' necessario lasciar raffreddare lo sci e dopo l'applicazione dello stick tirarlo in modo leggero e rapido con il sughero sintetico. In caso sciolinatura klister a basse temperature è necessario munirsi di fiamma a gas portatile per riscaldare le scioline e riuscire a miscelarle e tirarle con il pollice o il palmo della mano.

INDICATIONS:

It is suggested to use always a basic layer of stick S60 ORANGE hot by passing the waxing iron. The layer thickness depends on the snow abrasion factor. The complete waxing requests at least 3 layers, even different, spread from time to time with synthetic cork.

It is suggested to use a basic layer of klister K82 GREEN hot by means of the waxing iron. The layer thickness depends on the snow abrasion factor. The complete waxing requests at least 2 layers, even mixed, from time to time with your thumb. When the snow becomes icy, it is suggested to use the stick as indicated in the tabel to cover the klister and so avoiding that it ices loosing the gripping effect. After application of the stick, wait for the ski to cool down, then use the synthetic cork slightly and quickly. In case of klister waxing with low temperature, use a portable gas flame to heat the wax and mix it, then spread it with your thumb or the palm of your hand.

MODE D'EMPLOI:

Il est conseillé de mettre toujours une couche de stick de base S60 ORANGE à chaud, avec le fer de fartage. L'épaisseur de la couche dépend de l'abrasivité de la neige. Le fartage complet requiert au minimum 3 couches de stick superposées, même différentes, et étirées chaque fois avec le liège synthétique.

Il est conseillé de mettre toujours une couche de klister de base K82 GREEN à chaud, avec le fer de fartage. L'épaisseur de la couche dépend de l'abrasivité de la neige. Le fartage complet requiert au minimum 2 couches de klister superposées,

même mélangées, et étirées chaque fois avec le pouce. vec la neige qui a tendance à glacer, il est conseillé d'utiliser les sticks, comme indiqué sur le tableau, pour couvrir les klisters en évitant qu'ils ne glacent, ce qui diminuerait la prise. Il faut laisser refroidir le ski, et après avoir appliqué le stick passer légèrement et rapidement avec le liège synthétique. En cas de fartage au klister à basse température, il faut se munir d'une flamme à gaz portable, pour chauffer les farts et pour pouvoir les mélanger, et les étirer avec le pouce ou avec la paume de la main.

TIPP:

Die Steigwachse werden auch zum Abdecken der Klister eingesetzt, womit verhindert werden soll, dass letztere aneisen und damit der Abstoss des Ski verloren geht. Es ist notwendig den Ski abkühlen zu lassen, bevor das Steigwachs mit einem Synthetikork eingearbeitet wird, wobei dieses rasch, aber ohne grossen Druck verrieben wird. Wenn Klister bei kalten Temperaturen gewachst werden, kann es notwendig sein sich einer Gasflamme zu bedienen, um die verfestigten Klister zuerst aufzuwärmen und zu verflüssigen und diese dann mit dem Daumen oder Handballen zu verreiben.

ПРЕДПОСЫЛКА:

Рекомендуется всегда наносить один слой базы stick S60 ORANGE и разогревать утюгом для лыжных мазей. Толщина слоя базы зависит от жёсткости снега. Чем абразивнее снег, тем толще слой базы. Нанесение лыжной мази в полном комплекте требует как минимум 3 слоя stick, даже разного типа, но каждый раз необходимо растирать синтетической пробкой.

Рекомендуется всегда наносить один слой базы klister K82 GREEN и разогревать утюгом для лыжных мазей. Толщина слоя базы зависит от жёсткости снега. Нанесение лыжной мази в полном комплекте требует как минимум 2 слоя klister, можно смешивать, но каждый раз необходимо растирать большим пальцем. При снеге, который может заledenеть, рекомендуется использовать stick, как указано в таблице, чтобы покрыть klister и исключить риск недержания лыж. Необходимо оставить лыжи охлаждаться и после нанести stick, растирая синтетической пробкой лёгкими и быстрыми движениями. В случае использования klister при низких температурах, необходимо запастись переносной газовой горелкой для разогрева мази, чтобы удалось нанести её на колодку и размазать большим пальцем или ладонью.

ZPŮSOB POUŽITÍ:

Doporučuje se jako základní vrstvu za použití žehličky použít STICK S60 ORANGE HOT. Tloušťka vrstvy závisí na faktoru abrazy sněhu. Kompletní ošetření vyžaduje alespoň 3 vrstvy, které mohou tvořit různé typy vosku, rozetřené syntetickým korkem.

Doporučuje se jako základní vrstvu za použití žehličky použít KLISTER K82 GREEN HOT. Tloušťka vrstvy závisí na faktoru abrazy sněhu. Kompletní ošetření vyžaduje alespoň 2 vrstvy, které mohou tvořit různé typy klistru, rozetřené palcem. Pokud sníh začne mrznout, je třeba použít STICK tak, jak je uvedeno v tabulce. Tím dojde k překrytí klistru a předejde se jeho ztuhnutí a ztrátě odrazového efektu. Po aplikaci vosku vyčkejte, až lyže zchladne, a poté rychle a zlehka rozetřete syntetickým korkem. V případě použití klistru při nízké teplotě užijte k zahřátí vosku přenosný plynový hořák, smíchejte s klistrem a rozetřete palcem nebo dlaní.

SOLID RACING WAX KIT

BMC0001



FP4 HOT-SUPERMED 20gr
HP3 RED-YELLOW1-ORANGE1 50gr
LP2 GREEN-BLUE-VIOLET-RED 100gr
BP1 VIOLET -RED - SOFT BASE 250gr
HARD BRASS/HARD HORSE HAIR/SOFT NYLON BRUSHES
PLEXY SCRAPER/PLEXY SHARP/CORK-NYLON BRUSH
ELECTRONIC IRON WAX/SKI VISE RACING

LIQUID RACING WAX KIT

BMC0002



FP4 HOT-SUPERMED 50ml
HP3 MED-HOT 75ml
LP2 COLD-MED - BP1 COLD 150ml
SOFT BASE - MED BASE 250gr
HARD BRASS/HARD HORSEHAIR/SOFT NYLON BRUSHES
PLEXY SCRAPER/PLEXY SHARP/CORK-NYLON BRUSH
IRON WAX/SKI VISE RACING

WAXING & EDGE TUNING KIT

BMC0003



LP2 VIOLET-RED 100gr
BP1 VIOLET-RED 250gr
HARD BRASS/HARD HORSE HAIR/SOFT NYLON BRUSHES
PLEXY SCRAPER/PLEXY SHARP/SIDEWALL SHARP
ALUMINIUM SQUARE 88°/SKIFILE CLAMP/FILE BRUSH
SKIFILE HARD CHROME SUPERCOARSE-COARSE 200mm
DIAFACE 400-600gr 100mm/GUMMY STONE
IRON WAX/SKI VISE RACING

EDGE TUNING KIT

BMC0004



SIDEWALL SHARP/ADJUSTABLE BASE BEVEL TOOL
ALUMINIUM SQUARE 88°-87°/SKIFILE CLAMP
SKIFILE HARD CHROME SUPERCOARSE-COARSE-FINE 200mm
DIAFACE 400-600gr 100mm/ARKANSAS STONE
GUMMY STONE/FILE BRUSH/SKI VISE RACING

SPEED FABRIC ROLLERS

Alpine/Nordic/Snowboard

SPREADING ROLLER POLYESTER

MT0070 cm 10
MT0075 cm 14
MT0080 cm 20



BRUSHING ROLLER MERINO WOOL 5mm

MT0071 cm 10
MT0076 cm 14
MT0081 cm 20



POLISHING ROLLER MERINO WOOL 10mm

MT0072 cm 10
MT0077 cm 14
MT0082 cm 20



ROTO KIT CM 10 MT0085



ROTO KIT CM 14 MT0086



ROTO KIT CM 20 MT0087



Apply hot or cold every perfluorinated wax FP4(powder, spray or solid) or liquid paraffins as recommended in the waxing manual Briko-Maplus Ski Wax, available on www.brikomaplus.it. Instead of roto-cork and traditional horsehair and nylon brushes use new rollers of polyester and merino wool as follows:



1. Roll the base surface with the roto-polyester in both directions at a speed between 1000 and 1500 rpm according to the pressure applied. Repeat several times until the complete saturation of the base surface. Wait at least 10 minutes for cooling of the base surface and for the ski wax to harden.
2. Free the base structure with the 5 mm. roto-wool.
3. Polish the base structure with the 10 mm. roto-wool.

For top performances is necessary one set of new rollers for every type of product (cold-med-hot).

QUICK GRIP
MT0030



DRIVE SHAFT
MT0031 10 cm
MT0032 14 cm
MT0033 20 cm



HARD HORSEHAIR
MT0012 10 cm



SOFT HORSEHAIR
MT0016 10 cm



CORK
MT0022 10 cm



SOFT NYLON
MT0013 10 cm



BRASS
MT0011 10 cm



STEEL
MT0017 10 cm



ROTO KIT 10 CM - CORK
MT0050 (MT0030 + MT0031 + MT0022-12-13)



ROTO KIT 10 CM - BRASS
MT0055 (MT0030 + MT0031 + MT0011-12-13)



CORK
MT0024 14 cm



HORSEHAIR
MT0042 14 cm



NYLON
MT0043 14 cm



XC COMBI 1
MT0049 14 cm



hard horsehair-soft nylon

HORSEHAIR
MT0014 20cm



NYLON
MT0015 20cm



BRASS
MT0018 20cm



STEEL
MT0019 20cm



ROTO KIT 10 CM - POLYESTER
MT0056 (MT0030 + MT0031 + MT0070-12-13)



Alpine/Nordic/Snowboard

XC ROTO KIT

BK00060 80 mm



bristle with brass
hard bristle - horsehair
QUICK GRIP AND DRIVE SHAFT INCLUDED

XC BRISTLE WITH BRASS

BK00061 80 mm



QUICK GRIP AND DRIVE SHAFT INCLUDED

ALPINE ROTO KIT

BK00065 110 mm



bristle with brass
hard bristle - horsehair
QUICK GRIP AND DRIVE SHAFT INCLUDED

BRISTLE WITH BRASS

BK00066 110 mm



QUICK GRIP AND DRIVE SHAFT INCLUDED

HORSEHAIR

BK00067 110 mm



QUICK GRIP AND DRIVE SHAFT INCLUDED

ROTO CORK & WOOL APPLICATOR KIT

BK00070 115 mm



DRIVE SHAFT WITH FIX GRIP

WOOL APPLICATOR

BK00071 115 mm



MANUAL BRUSHES

Alpine/Nordic/Snowboard

HARD HORSEHAIR
MT0101



SOFT HORSEHAIR
MT0104



HARD NYLON
MT0105



SOFT NYLON
MT0102



HARD BRASS
MT0106



SOFT BRASS
MT0103



STEEL
MT0107



HARD HORSEHAIR
MT0121



SOFT HORSEHAIR
MT0124



HARD NYLON
MT0125



SOFT NYLON
MT0122



HARD BRASS
MT0126



SOFT BRASS
MT0123

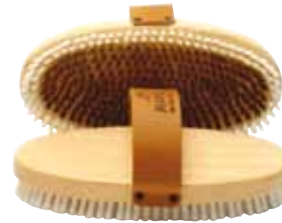

STEEL
MT0127



STEEL STRUCTURE BRUSH
BK00130



WAXING TOOLS

CORK

MT0110 70 x 50 x 35 mm



CORK/NYLON BRUSH

MT0111 75 x 55 x 34 mm



SYNTHETIC CORK

MT0113 70 x 50 x 35 mm



NORDIC SCRAPER

MT0510



GROOVE SCRAPER

MT0512



PLEXY SCRAPER

MT0511 130 x 60 x 4 mm

MT0516 140 x 60 x 5 mm



STEEL SCRAPER

MT0513 1 mm



SNOWBOARD SCRAPER

MT0515 260 x 70 x 5 mm



SKIMAN BOX

BMC0100



Outside dim. in mm.

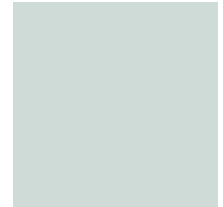

FIBERLENE TAPE**MT0900** 10 mt x 130 mm**PTFE TAPE****MT0901** 10 mt x 130 mm**PTFE SHEET****MT0902** 10 pcs
200 x 130 mm**STANDARD
THERMOMETER
MT0915**temp. $-20^{\circ}/+50^{\circ}$ **DIGITAL PROBE
THERMOMETER
MT0921**temp. $-40^{\circ}/+200^{\circ}$ **INFRARED
EASY THERMOMETER
MT0922**temp. $-33^{\circ}/+110^{\circ}$ **INFRARED
THERMOMETER GUN
MT0916**temp. $-33^{\circ}/+500^{\circ}$ **POCKET
THERMO-HYGROMETER
MT0923**temp. $-20^{\circ}/+50^{\circ}$
hr. 10%/95%**DIGITAL
THERMO-HYGROMETER
MT0920**temp. $-40^{\circ}/+70^{\circ}$
hr. 1%/99%

SAND PAPER

BK00950 gr 180 5 pcs



120 x 200 mm

SAND PAPER

BK00951 gr 120 5 pcs



120 x 200 mm

SKI STOPPER ELASTIC

MT0955 2 pcs



PAPER PROTECTION

BK00953 20 pcs



115 x 205 mm

ELASTICS FOR BINDING

SM058100 1 kg



WAXING THERMO BAG
MT0800 - AC 220V



(10 alpine ski or 20 XC ski - 55°C x 24h - for ski base saturation)

**WAXING THERMO-
COVER - ALPINE**
MT0801 - AC 220V
MT0801US - AC 110V



2300mm x 145mm

**WAXING THERMO-
COVER - JUMPING**
MT0801JP - AC 220V



3000mm x 185mm

**WAXING THERMO-
COVER - NORDIC**
MT0801XC - AC 220V



2300mm x 145mm

**CLAMP FOR
THERMO-COVER**
MT0802



for alpine and jumping

(55°C x 3h for quick ski base saturation)

SKI LAB ACCESSORIES

PROTECTIVE MASK
KZ08005



TRUE BAR
MT0514 3 mm



Steel Scraper

HOLE PLUGS
LK21101 500 pcs



Mixed Normal Colors

**PLASTIC BUSHING
THREADED**
LK21201 100 pcs



Black

**STEEL
SKI DRILL**
MM420L 3,5 x 7 mm
MM420L 3,5 x 9 mm
MM420L 3,8 x 10 mm
MM420L 3,8 x 15 mm
MM420L 4,1 x 9 mm



**HARD STEEL
SKI DRILL**
MM420CO 4,1 x 9 mm



SCREW DRIVER BIT
MMF4302 pzd2 x 110 mm
A4 standard



SCREW DRIVER BIT
MMF4303 pzd3 x 110 mm
A4 standard



HARD CHROME
ML0002 200 mm



fine

HARD CHROME
ML0003 200 mm



coarse

HARD CHROME
ML0004 200 mm



super coarse

HARD CHROME
BK00010 150 mm



coarse

HARD CHROME
ML0001 150 mm



fine

BODY FILE
ML0005 300 mm



FILE BRUSH
MT0100



**PROFESSIONAL
HARD CHROME**
ML0501 200 mm



bastard

**PROFESSIONAL
HARD CHROME**
ML0502 200 mm



2nd cut

**PROFESSIONAL
HARD CHROME**
ML0503 150 mm



smooth

**PROFESSIONAL
NO-CHROME**
ML0511 200 mm



bastard

**PROFESSIONAL
NO-CHROME**
ML0512 200 mm



2nd cut

**PROFESSIONAL
NO-CHROME**
ML0513 150 mm



smooth

**PRO-RS
NO-CHROME**
ML0525 100 mm



coarse

**PRO-RS
NO-CHROME**
ML0526 100 mm



medium

**PRO-RS
NO-CHROME**
ML0527 100 mm



fine

DIAFACE RIGID
MP0210 70 mm
MP0200 100 mm



gr. 100

DIAFACE RIGID
MP0211 70 mm
MP0201 100 mm



gr. 200

DIAFACE RIGID
MP0212 70 mm
MP0202 100 mm



gr. 400

DIAFACE RIGID
MP0213 70 mm
MP0203 100 mm



gr. 600

DIAFACE RIGID
MP0214 70 mm
MP0204 100 mm

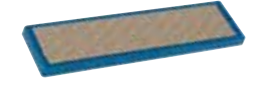

gr. 1000

**WORLD CUP
DIAMOND**
MP0310 70 mm
MP0300 100 mm

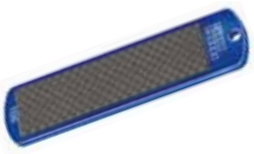

gr. 100

**WORLD CUP
DIAMOND**
MP0311 70 mm
MP0301 100 mm

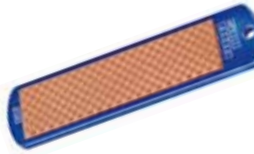

gr. 200

**WORLD CUP
DIAMOND**
MP0312 70 mm
MP0302 100 mm

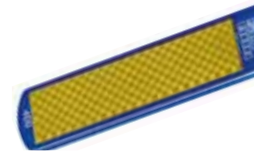

gr. 400

**WORLD CUP
DIAMOND**
MP0313 70 mm
MP0303 100 mm

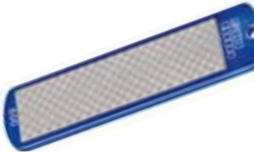

gr. 600

**WORLD CUP
DIAMOND**
MP0314 70 mm
MP0304 100 mm

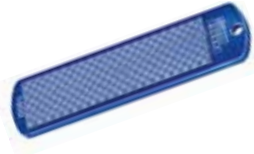

gr. 1000

MINI SQUARE 88°
MP0150



for diamond 70 mm

MINI SQUARE 87°
MP0151



for diamond 70 mm

POCKET DIAMOND
MP0005



gr. 200

GUMMY STONE
MP0010



fine

NATURAL STONE
MP0003



medium

NATURAL STONE
MP0002



fine

ARKANSAS
MP0004



extra fine

ALU OXIDE STONE
BK00006



medium

SAND PAPER
BK00008 5 pcs



gr. 600 - 70 x 200 mm

SKI MAN FOLDING TABLES

UNIVERSAL SKIMAN TABLE

MT0610 (Bag included)



Adjustable arms

ALPINE SKIMAN TABLE

MT0611 (Bag included)



Aluminium light weight

NORDIC SKIMAN TABLE

MT0612 (Bag included)



Aluminium light weight

NORDIC PROFESSIONAL PROFILE

MT0623



TABLE BAG

MT0608

For Table MT0610

MT0628

For Table MT0611

MT0612



NORDIC SKI VISE

MT0613



CENTRAL CLIP

MT0617



SKI RACK

MT0614

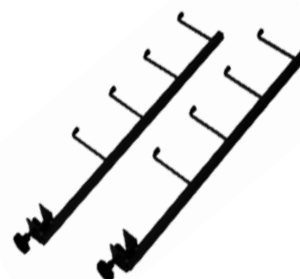

IRON HOLDER

MT0620



RUBBISH BAG HOLDER

MT0621



ELECTRONIC IRON WAX

KZ06000 AC 220V

KZ06001 AC 110V



WORLD CUP ELECTRONIC IRON WAX

KZ04500 AC 220V

KZ04501 AC 110V

**HIGH PERFORMANCE
ANTI DIRT
SPECIAL BASE**



IRON WAX

KZ05000 AC 220V

KZ05001 AC 110V



WORLD CUP ELECTRONIC IRON WAX

KZ04000 AC 220V

KZ04001 AC 110V



AIR HEATER GUN

KZ07000 AC 220V

AIR HEATER IRON SCRAPER

KZ07001 Ø 38mm

FACIAL MASK

KZ08000

FILTER FOR FACIAL MASK

KZ08001



SKI BASE

LK00001 trasparente
LK00002 graphite
250 x 130 x 1,3 mm

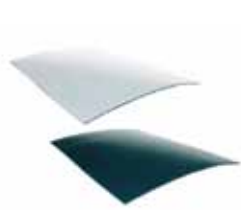

4 pcs

FREE CANDLE Ø 8mm

LK20001 trasparente
LK20002 graphite
LK20003 black



1 kg

GUN CANDLE Ø 11,5mm

LK20301 trasparente
LK20302 graphite
LK20303 black



1 kg

WELDING STRIP

LK20401 trasparente
LK20402 graphite
LK20403 black



1 kg

WIRE FOR SMEARING MACHINE Ø 3mm

LK20601 trasparente
LK20602 graphite
LK20607 black



0,5 kg

WIRE FOR SMEARING MACHINE Ø 3mm

LK20661 trasparente
LK20662 graphite
LK20667 black



1,5 kg

METAL GRIP

Ø 3,5mm
LK20902 trasparente
LK20904 graphite



10 mt

SKI AND SNOWBOARD VISES

SKI VISE 24 HOURS
SM00650



SKI VISE HOLDING
SM00680 (max opening 80 mm)



SKI VISE QUICK
SM00690



SKI VISE COMP
SM00691 (max opening 85 mm)



CROSS COUNTRY SUPPORT
SM00625 (only for SM00691)



SKI VISE RACING

SM01070 (max opening 100 mm)



SKI VISE PRO

SM01110 (max opening 100 mm)



SKI VISE PRO "WIDE OPENING"

SM01110W (max opening 155 mm)



SKI VISE JUMP
SM00994



SKI VISE CROSS COUNTRY
SM00670



BOARD STOPPER
SM01003



DOUBLE WORKSHOP VISE
SM01021



DOUBLE WORKSHOP SUPPORT
SM01022

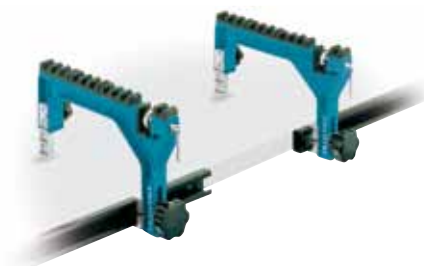

RACING SHARP
SM05006



RACING SHARP KIT
SM05007



Side edge:89°-88°-87°-86° / Base edge:0,5°- 1°

QUICK SHARP 88°-89°
SM03007



QUICK SHARP KIT 88°-89°
SM03009



SPARE ZIRCONIUM
SM05140



SPARE DIAMOND
SM05160



SPARE FILE
SM05104 80 mm
SM05105 40 mm

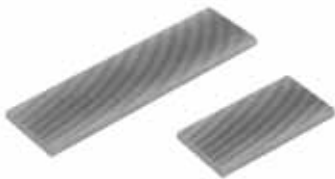

Bastard

ERGONOMIC SHARPENER
SMK03000 88°



TOURING SHARPENER
SMK04003 90°-89°-88°-87°



ROTO GUIDE
SMK03010 90°
SMK03011 89°
SMK03012 88°
SMK03013 87°



ERGO SHARP
SM05002



from 90° to 85°

PLEXI SHARP
SM00630



SPARE PANZER FILE
SM05101



ADJUSTABLE BASE BEVEL TOOL

SM03071 from 0,5° to 1,5°

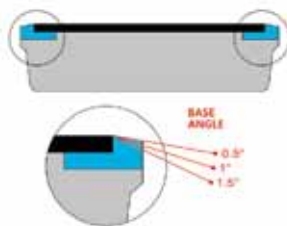

RACING GUIDE

SM03030	90°
SM03031	89°
SM03032	88°
SM03033	87°
SM03034	86°

RACING GUIDE PLUS

SM03040	90°
SM03041	89°
SM03042	88°
SM03043	87°
SM03044	86°



INOX SQUARE

SQ0090	90°
SQ0089	89°
SQ0088	88°
SQ0087	87°
SQ0086	86°
SQ0085	85°

SKI FILE CLAMP

MT0803



ALUMINIUM SQUARE

SQ0090V	90°
SQ0089V	89°
SQ0088V	88°
SQ0087V	87°
SQ0086V	86°
SQ0085V	85°



SIDEWALL SHARP
SM03004



SIDEWALL RAZOR
SM05004



SIDEWALL PRO SHARP
SM05005

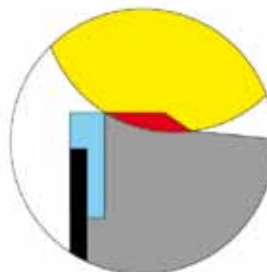

remove before filing

SPARE BLADE STANDARD
SM05120



SPARE BLADE ROUND
SM05130



BRAVO SHARP
SM07001 from 90° to 86°
Electric side edge sharpener
for ski & snowboard tuning



SPARE BANDS COARSE
SM07002 10 pcs.



SPARE BANDS FINE
SM07003 10 pcs.



NORDIC SHARP
SM08001



Art. SM08006 included



LINEAR COARSE
SM08002
for warm and wet conditions



LINEAR MEDIUM
SM08003
for universal conditions

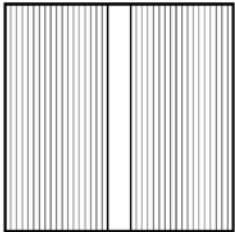

LINEAR FINE
SM08004
for cold conditions



DIAGONAL COARSE
SM08005
for warm and wet conditions



DIAGONAL MEDIUM
SM08006
for universal conditions

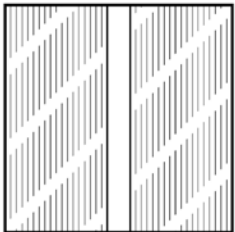

DIAGONAL FINE
SM08007
for cold conditions



W COARSE
SM08008
for warm and wet conditions



W MEDIUM
SM08009
for universal conditions

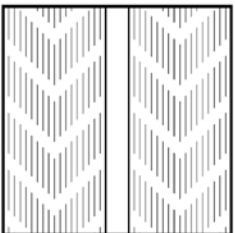

W FINE
SM08010
for cold conditions

FLASH

MSK0010 L. 530 mm
SKATING RACING



Free polyurethane wheels 80

SPEED

MSK0025 L. 530 mm
SKATING LIGHT TRAINING



Free polyurethane wheels 78

SPEED

MSK0029 L. 600 mm
SKATING TRAINING



Free natural rubber wheels

EASY

MSK0030 L. 700 mm
CLASSIC TRAINING



2 no-reverse device
polyurethane weels

EASY

MSK0035 L. 700 mm
CLASSIC HARD TRAINING



2 no-reverse device
natural rubber wheels

TWIN

MSK0040 L. 700 mm
VERY HARD TRAINING



2 no-reverse device
natural rubber wheels

PROGRESS

MSK0080 L. 700 mm
CLASSIC RACING



4 no-reverse device
polyurethane wheels 78

TRIS

MSK0070 L. 660 mm
CLASSIC RACING



6 no-reverse device
polyurethane wheels 78

TRIS

MSK0060 L. 660 mm
CLASSIC TRAINING



6 no-reverse wheels
polyurethane wheels 78

VASAROAD carbon

MSK0085 L. 720 mm
CLASSIC HARD TRAINING
REAL SKI FEELING

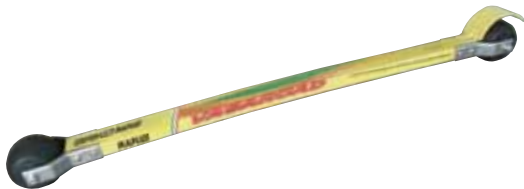

2 no-reverse device
natural rubber wheels

SKIROLL BAG

MSK2000



**FORK
SET**
MSK0300
EASY
MSK0310
TWIN



**SPLASH
GUARD**
MSK0400
EASY - TWIN



BEARING
MSK0550
FLASH
MSK0500
OTHER MODELS



VASAROAD
MSK1610
WITHOUT BEARINGS
MSK1620
FREE
MSK1630
NO-REVERSE DEVICE



PROGRESS
MSK1510
WITHOUT BEARINGS
MSK1530
NO-REVERSE DEVICE



BEARING BUSH
MSK0600
EASY - TWIN
MSK0610
OTHER MODELS



**COMPLIT
NO-REVERSE DEVICE**
MSK0700
EASY - TWIN
MSK0710
FLASH - TRIS SR
MSK0720
SPEED - TRIS JR



**NO-REVERSE
DEVICE BUSH**
MSK0800
EASY - TWIN
MSK0810
OTHER MODELS



**WHEEL SHAFT-
SPACERS-NUT**
MSK0900
EASY
MSK0910
TWIN
MSK0930
TRIS SR BACK WHEELS
MSK0950
OTHER MODELS



FLASH-TRIS
MSK1010
WITHOUT BEARINGS
MSK1020
FREE
MSK1030
NO-REVERSE DEVICE



polyurethane 80

FLASH-TRIS
MSK1015
WITHOUT BEARINGS
MSK1025
FREE
MSK1035
NO-REVERSE DEVICE



polyurethane 78

FLASH-TRIS
MSK1060
WITHOUT BEARINGS
MSK1070
FREE
MSK1080
NO-REVERSE DEVICE



polyurethane 78

TWIN
MSK1310
WITHOUT BEARINGS
MSK1320
FREE
MSK1330
NO-REVERSE DEVICE



natural rubber

SPEED
MSK1110
WITHOUT BEARINGS
MSK1120
FREE
MSK1130
NO-REVERSE DEVICE



polyurethane 78

SPEED
MSK1160
WITHOUT BEARINGS
MSK1170
FREE
MSK1180
NO-REVERSE DEVICE

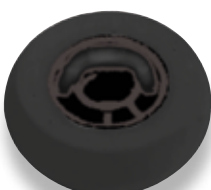

natural rubber

EASY
MSK1210
WITHOUT BEARINGS
MSK1220
FREE
MSK1230
NO-REVERSE DEVICE



polyurethane

EASY
MSK1240
WITHOUT BEARINGS
MSK1250
FREE
MSK1260
NO-REVERSE DEVICE



natural rubber

ACCESSORIES

SKIMAN APRON
COTTON MA0003



**BUTTONS
NECK SHIRT**
MA0008 Short sleeves
MA0018 Long sleeves



NORDIC SKI CLIP
MA0005



NORDIC SKI STRAP
MA0025



ALPINE SKI STRAP
MA0004



PATCH
MA1003B BLACK
MA1003W WHITE



PATCH
MA1033B BLACK
MA1033W WHITE



SKI HOLDING STRIPE
MA0015



For XC & Alpine ski

ALPINE SKI COVER
BK00020 1,80-2,05 mt
BK00021 2,00-2,25 mt



CAP
MC0550



LYCRA HAT
MC0001B BLACK
MC0001W WHITE

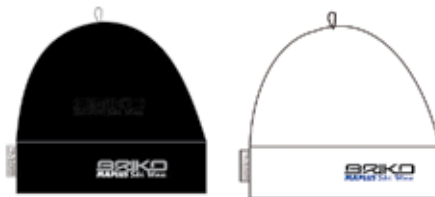

Nordic Racing

CAP
MC0050



PAPER ADHESIVE TAPE
MA1014



ADHESIVE TAPE
MA1004



NO-ADHESIVE SKI TAPE
MA1044



THERMO WAIST BAG
MA0007



STICKERS
MA1001 310x50mm
MA1002 830x140mm



FLAG
MA1008 0,66x4,20mt



**TRAVEL BACK-PACK
WITH TROLLEY**
MB0044



SKIMAN WAIST BAG
MB0033



SKIMAN BACK PACK
MB0004



PROFESSIONAL SKI BAG
MB0005 425x330x200mm



XC DISPLAY

MA1110 400x820x400mm



STAND WITH WHEELS

MA1120 0,64x1,86x0,50mt

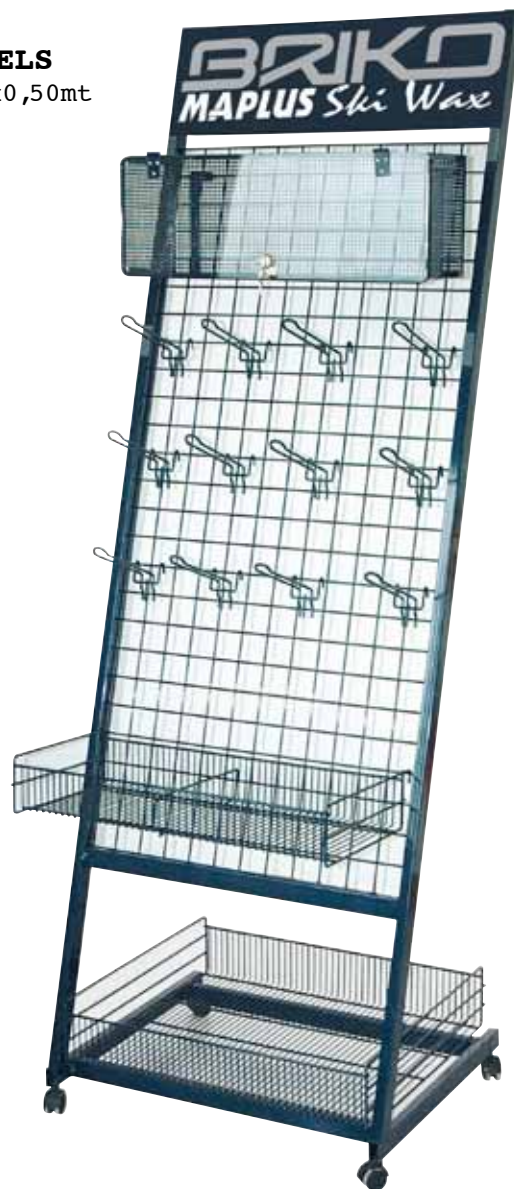

KIT DISPLAY

MA1100 425x330x200mm



HOOK FOR STAND WITH WHEELS

MA1200



NON WOVEN BANNER

MA1005 0,80x4mt



BRIKO

MAPLUS Ski Wax

GUARNIFLON S.P.A. - BRIKO-MAPLUS DIVISION
VIA A. MORO, 80/82 - 24060 CASTELLI CALEPIO (BG) - ITALY
☎ +39 035 4494383 - 📠 +39 035 4425443
www.brikomaplus.it - e-mail: info@maplus.it



www.brikomaplus.it - **SKIMAN ONLINE** - **WAXING MANUAL**

BRIKO è un marchio registrato della Briko s.r.l. ed è utilizzato sotto licenza da Guarniflon s.p.a. Quanto oggetto del presente catalogo potrà essere modificato in qualunque momento ad insindacabile giudizio della Guarniflon s.p.a. o in conseguenza di sopravvenute disposizioni o normative incompatibili con quanto riportato. Non tutti i prodotti possono essere disponibili in ogni Paese.

BRIKO is a registered trade mark of Briko s.r.l. and it is used under licence by Guarniflon s.p.a. Guarniflon s.p.a. reserves the right to modify or discontinue any product. Every product may not be available in all countries.

BRIKO est une marque déposée de BRIKO SRL et est utilisée sous licence par Guarniflon s.p.a. La Société Guarniflon s.p.a. se réserve le droit d'apporter toute modification à ce catalogue dans n'importe quel moment, à cause des normatives ou dispositions incompatibles avec son contenu. Pas tous les produits pourront être disponibles dans tous les Pays.

BRIKO ist eine registrierte handelsmarke von Briko s.r.l. und wird unter licence by Guarniflon s.p.a. benutzt. Guarniflon s.p.a. behält sich das Recht vor, Produkte zu modifizieren oder aus dem Lieferprogramm zu nehmen! Nicht alle Produkte sind in allen Ländern lieferbar!

Торговая марка **BRIKO** зарегистрирована Briko s.r.l. и используется Guarniflon s.p.a. в соответствии с лицензией. Содержание предоставленного каталога может быть изменено в любой момент и не подлежит критике рассуждений Guarniflon s.p.a., либо в случае последующих распоряжений или нормативов несовместимых с указанным в каталоге.

BRIKO je registrovan obchodn zna ka firmy Briko s.r.l. v licenci spole nosti Guarniflon s.p.a.

Spole nost Guarniflon s.p.a. si vyhrazuje pr vo upravit i p eru it prodej jak hokoli v robku. Produkty uveden v tomto katalogu nemus b t bezpodm ne n dostupn ve v ech zem ch.